



**Product Guide
&
Installation Instructions**

Table of Contents

Operating and Safety Instructions	1
Parts Diagram	2
Adjusting Hardware/Sash	3
Hinge and Unhinge Sash	4-5
Hardware Assembly	6
Insert Window & Door Install Instr.	7
Euro Door Installation Instructions	8-9

Operating and Safety Instructions

Minnkota Windows Euro Door

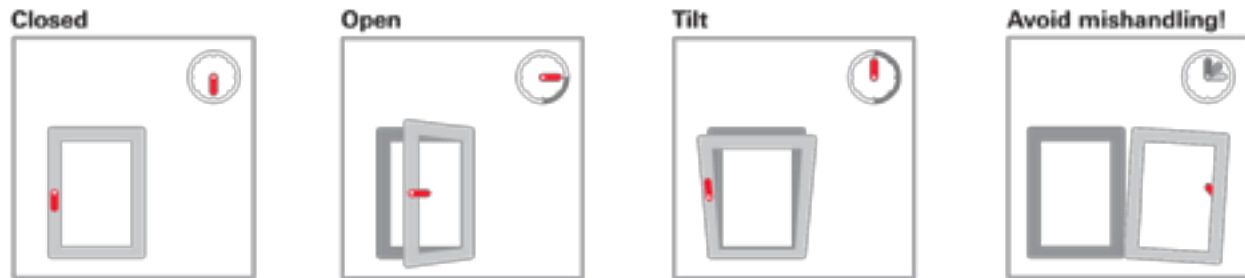

Minnkota Windows Euro Window

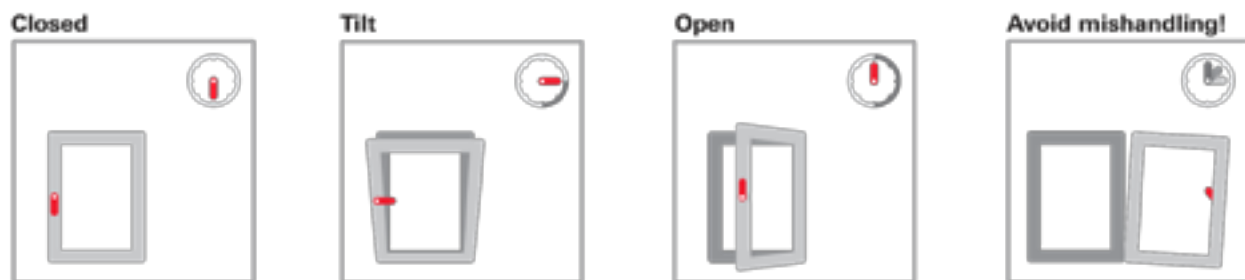

In order to preserve the **long term operation** of your window and to guarantee **security**, it is imperative to observe the following directives:

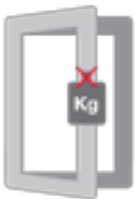

Do not subject the sash to additional loads.



Do not leave sashes open during strong winds.



Do not place any objects between the sash and frame.

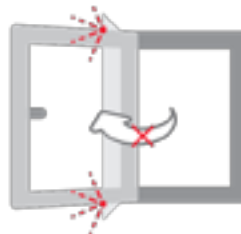

Do not allow the sash to hit or press up against the window reveal.



Risk of injury!
There is a risk of injury by catching one's finger or other body-parts in the opening gap. While closing, do not grasp between the sash and frame.



Risk of falling out!
Where children or other endangered persons have access to the window, the sash is to be safeguarded against turning. Install a child-safety lock or a key-lockable handle.



Euro Window Parts Diagram

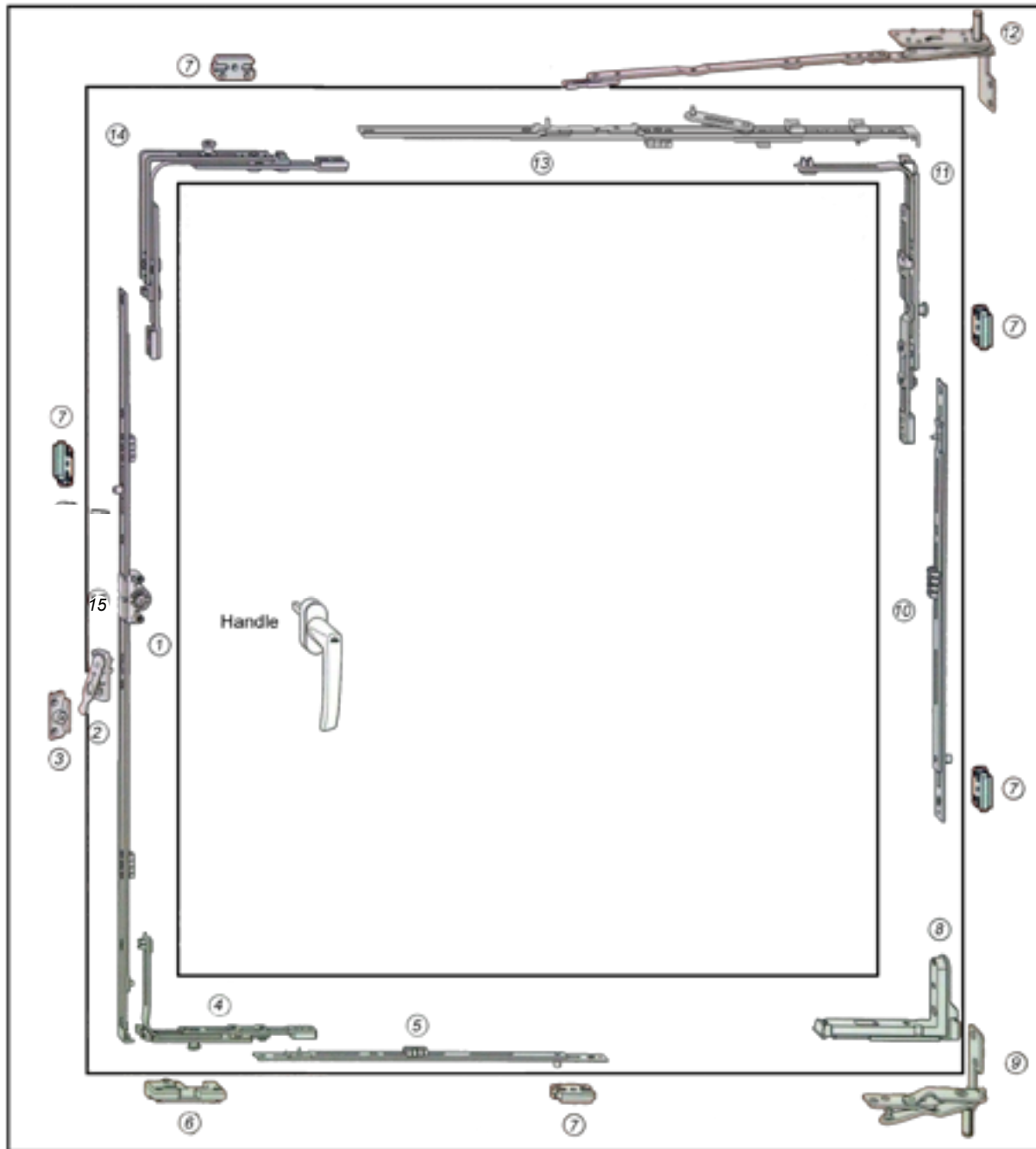

- | | |
|---|---|
| 1. Fixed handle-height espagnolette | 9. Pivot rest |
| 2. Lifting mishandling device (sash component) | 10. Vertical multipart center lock |
| 3. Lifting mishandling device (frame component) | 11. Stay corner drive |
| 4. Corner Drive (lower) | 12. Stay arm |
| 5. Horizontal multipart center lock (center lock P-cam) | 13. Stay arm guide |
| 6. Horizontal T & T striker | 14. Corner drive (upper) |
| 7. Security Striker | 15. Bullet catch plate (sash component) |
| 8. Corner Hinge | |



Hardware Adjustment

Tools Required: 4 mm Allen key

- There are areas located at the top and bottom hinge sides of the sash that allow the sash to be adjusted both vertically and laterally.
- The locking pins on the perimeter of the sash can also be rotated 90° to adjust the compressions rate of the sash weatherstrip gasket on the frame. (see diagram to the right)

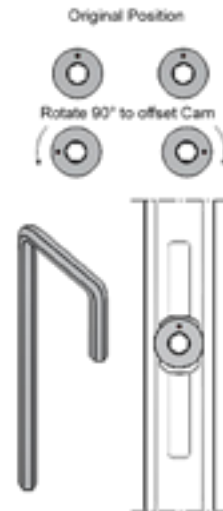

Via the sash stay:

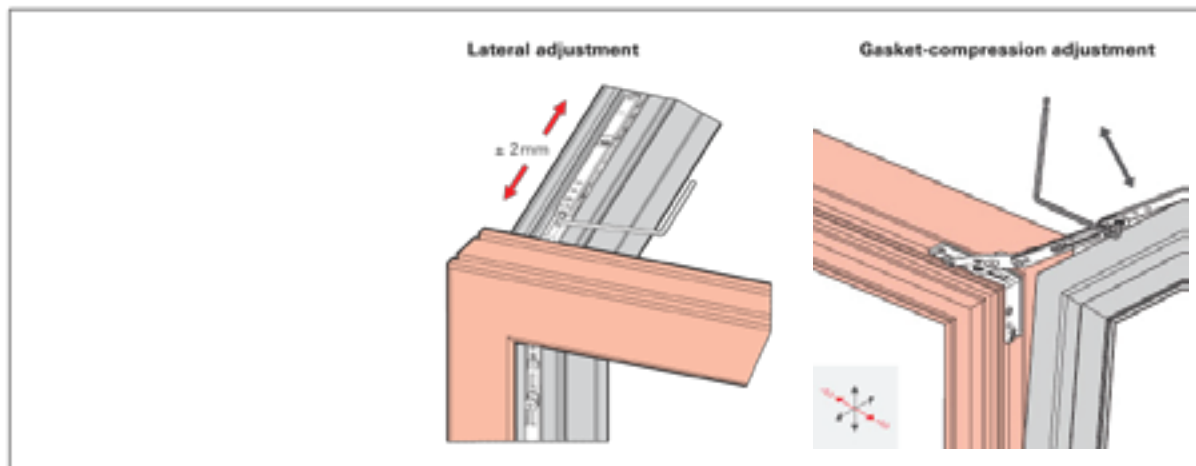

Via the pivot rest:

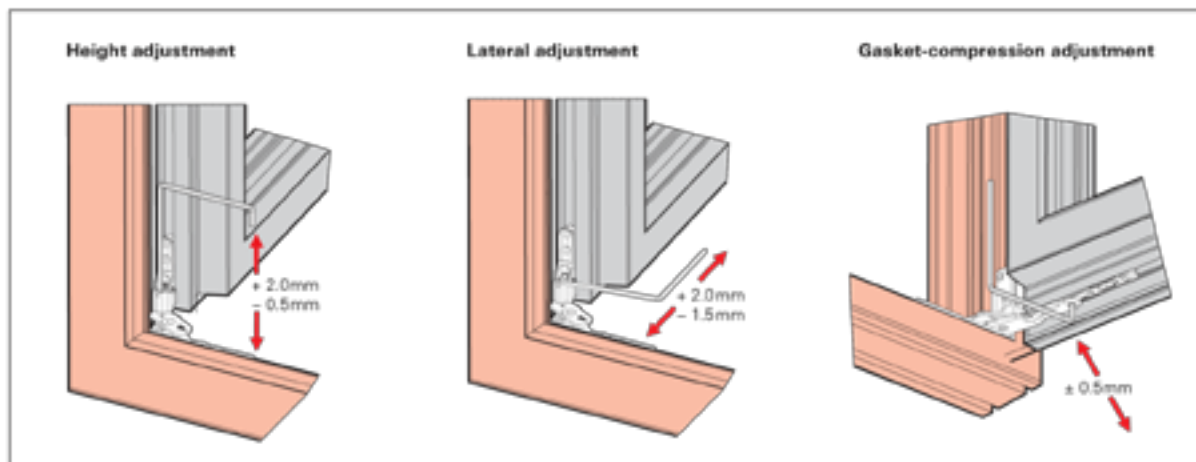

Hinging / Unhinging the sash -Sash stay 250*

Hinging the sash – sash stay 250

1. Press the lifting mishandling device (if installed).
2. Bring the handle into the tilt-mode.
This is a conscious – and in this case necessary – hardware mishandling operation!
3. Insert the sash in the pivot rest. **Important:** Do not tilt the sash in the process.

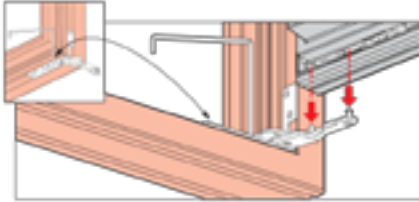

4. Press the stay arm onto the stay guide and supporting arm.

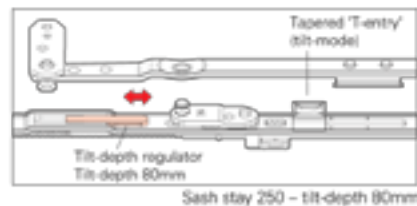
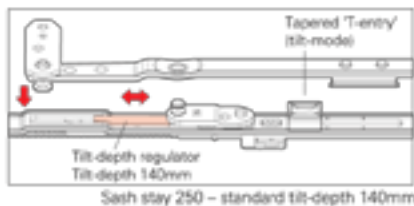

5. Close over the retainer-clasp.

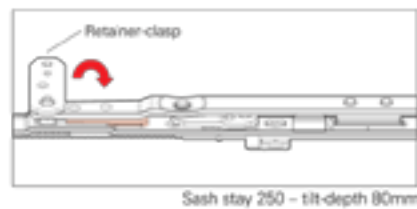
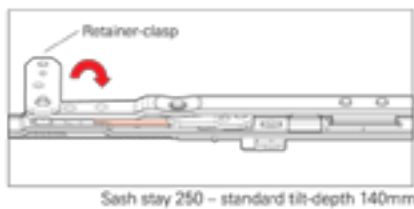

6. Operate the lifting mishandling device again.
7. Bring the handle into the turn-mode.

Unhinging the sash – sash stay 250

1. Open the sash 90°.
2. Slide back the corner hinge's anti-jemmy device with a 4mm Allen key.

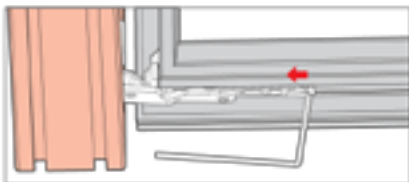

3. Press the lifting mishandling device (if installed).
4. Bring the handle into the tilt-mode.
5. Open the retainer-clasp.
6. Lift the stay arm off the stay guide and supporting arm.
7. Lift the sash from the pivot rest.

* 250 refers to Euro Windows or Doors with a frame width of less than 23 3/8"



Hinging / Unhinging the sash - Sash stay 350 & 500

Hinging the sash – sash stay 350 and 500

1. Press the lifting mishandling device (if installed).
2. Bring the handle into the tilt-mode.
This is a conscious - and in this case necessary - hardware mishandling operation!
3. Arrest the pivot rest with a 4mm Allen key and insert the sash into the pivot rest.

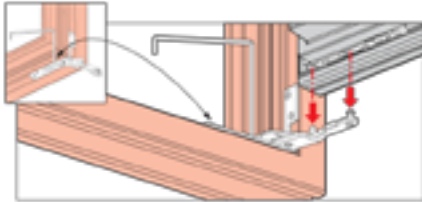

Important: Do not tilt the sash in the process.

4. Connect the sash stay's slider with the stay guide.

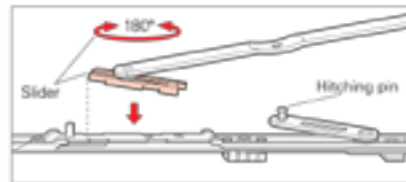
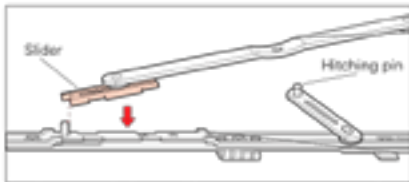

5. Pull up the stay arm and allow the supporting arm's hitching pin to snap in to the stay arm's hole.

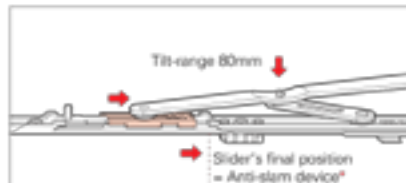
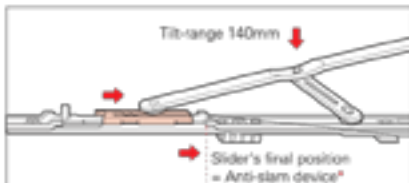

* The slider's final position (anti-slam device) is reached automatically by means of tilting the sash.

* The slider's final position (anti-slam device) is reached automatically by means of tilting the sash.

6. Operate the lifting mishandling device again.
7. Bring the handle into the turn-mode.

Unhinging the sash – sash stay 350 and 500

1. Open the sash 90°.
2. Slide back the corner hinge's anti-jemmy device with a 4mm Allen key.

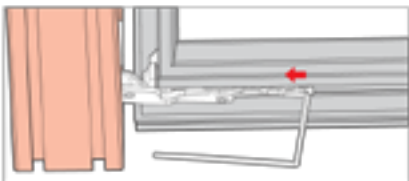

3. Press the lifting mishandling device (if installed).
4. Bring the handle into the tilt-mode.
5. Lift up the stay arm and release it from the hitching pin.
6. Detach the slider from the stay guide.
7. Lift the sash from the pivot rest.

* 350 & 500 refers to Euro Windows or Doors with a frame width greater than 23 3/8"



Installation Procedure

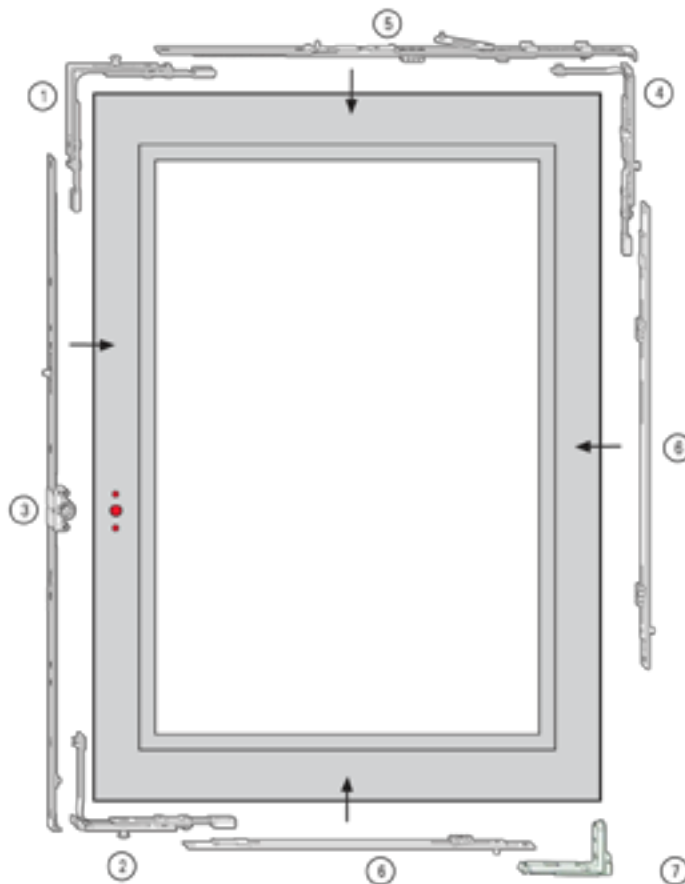

- ① Corner drive
- ② T&T corner drive
- ③ T&T espagnolette
- ④ Stay corner-drive
- ⑤ Stay guide
- ⑥ Center lock, vertical and horizontal
- ⑦ Corner hinge

Installation of Stay arm tilt restrictor

Standard tilt-depth (140 mm)

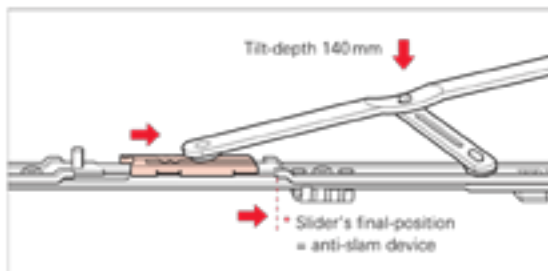
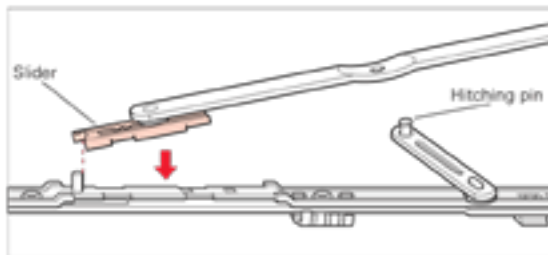

Reduced tilt-depth (80 mm)

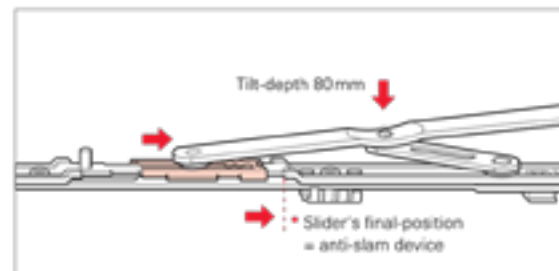
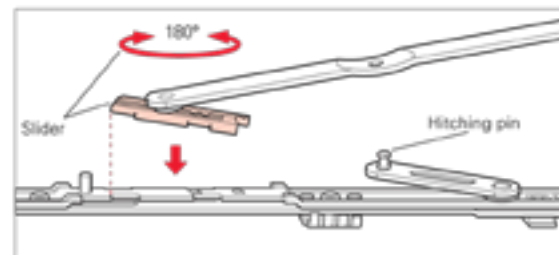

* The slider's final position (anti-slam device) is reached automatically by means of tilting the sash.



Insert Window & Door Installation Instructions

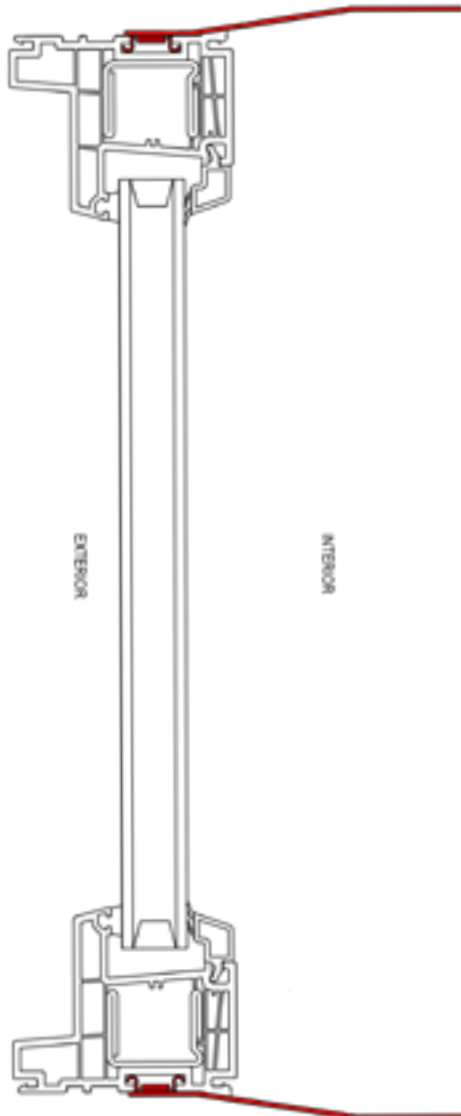
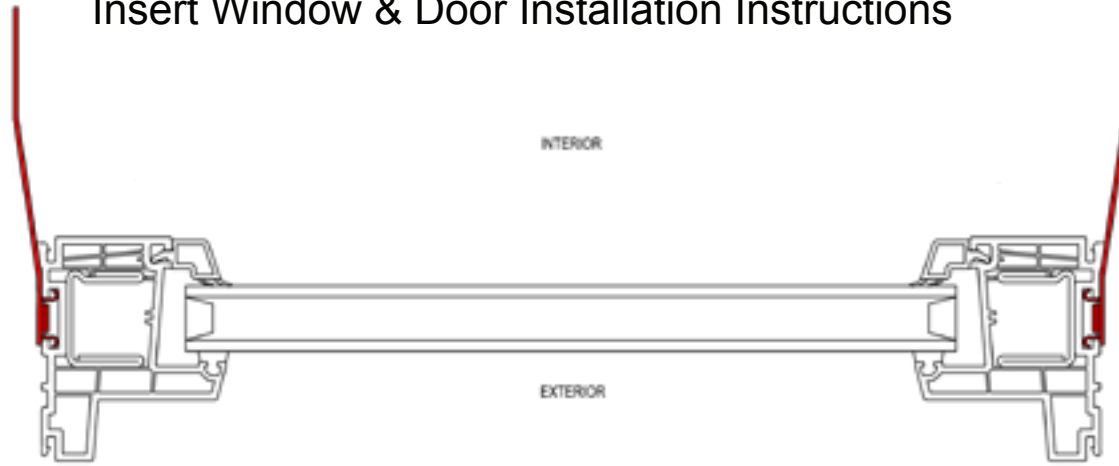

Recommended installation of REHAU window strap anchor. Bend anchor per each opening in field for tight fit to R.O. Place anchor at 6" from each end, 12" on center. Final install design and fastening requirements by others.



Installation Instructions - Euro Door

Option 1 (preferred)

GENERAL INFORMATION:

IMPROPER INSTALLATION AND CARE MAY VOID WARRANTY. THESE INSTRUCTIONS ARE A BASIC GENERAL RECOMMENDATION FOR INSTALLATION, AND MAY NOT BE UTILIZED IN EVERY APPLICATION METHOD. THE MANUFACTURER ASSUMES NO RESPONSIBILITY FOR FAILURE, PERFORMANCE OR INJURY FROM IMPROPER INSTALLATION METHODS, CARE AND OR USE.

Materials Needed:

- Screws—
- 1 1/4" for fastening wall fin or bucks/hold
- 2 1/4" for fastening thru interior of frame w/ cap plugs (Option #2)
- 4"x #5 pan head screw for fastening thru lock keepers (Option #1)
- High quality sealant w/ chalk gun
- Straight Flashing or building wrap tape
- Shims
- Flat Bar
- Tape measure
- Square
- Phillips head drill/driver
- Utility knife
- Hammer
- Batt Insulation or non-expanding window/door foam

Installing the Door:

(Preferred) OPTION #1

(fastening thru keepers, concealed screws method)

- **Prep opening and verify measurements, flash, shim, seal the door accordingly and per industry standards and codes.**
- 1. Set the bottom of the door sill onto the sill plate and carefully to push the door frame into the opening until the nail flange or brickmold is secured against the sheathing. Center the door and tack it into place before setting the shims and squaring up the door.
- 2. Make sure the door sill is level/straight and the side jambs are plumb and square (shim accordingly!)
 *If the frame of the PD sill is sagging or bowing in any fashion, it will cause the door panels to operate, look and seal improperly and may cause future damage to the door and it may not perform to its designed specifications!
- 3. Put 3-4 sets of shims along side jambs and header (if of shim locations varies depending on the size of the door) and align the shims with the lock keepers or where you will be fastening screws or using the 3/8" cap plugs.
- 4. With the primary and passive sash panels open, locate the keepers in which you will be using at least a 4", #5 pan head screw to fasten the door to the king studs, header and sill floor.
- 5. Remove one of the 1 1/4" pan head screws from the keepers on the main frame. (see Diagram A below) and using a 4", # 5 pan head screw, fasten the door thru the keeper and into the king stud, header and sill in ALL keepers around the frame perimeter, keeping the frame straight and level for optimal performance (DO NOT over tighten or distort jamb or mainframe).
- 6. Close the door panels and adjust shims accordingly so that the gap between the sash panels and side jambs, header and sill of the frame are uniform or that the reveals are consistent. Check the door for proper operation and function and re-adjust if necessary!
- 7. Finish fastening screws thru nail flange or Roto BM. Apply industry standard flashing over nail flange and screws/nails to insure air and water tightness.
- 8. Insulate between frame and rough opening and finish trimming the interior and exterior as needed.
- 9. Clean the sill after installation to clear debris from sill that may inhibit the locking points and/or drainage system of the door.

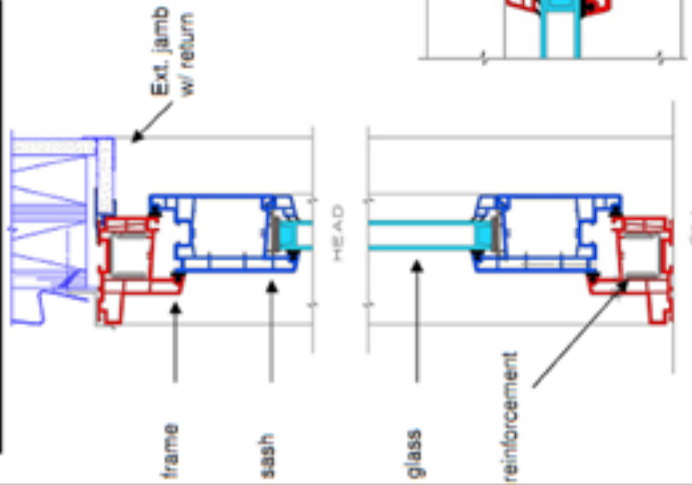

Method to fasten frame through keepers around door frame

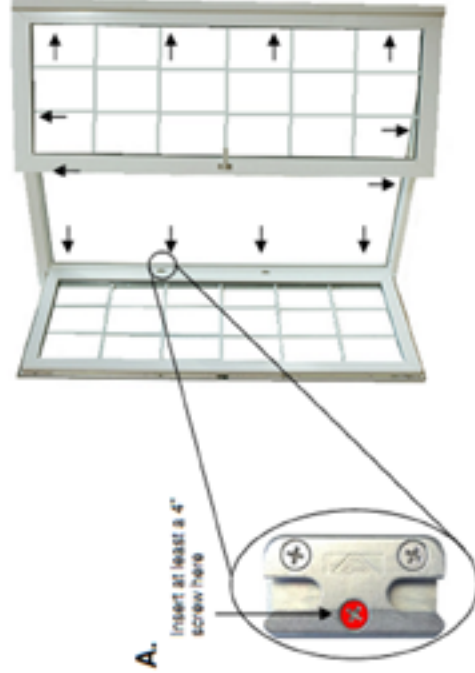

VERTICAL SECTION HORIZONTAL SECTION



Installation Instructions - Euro Door

Option 2

GENERAL INFORMATION:

IMPROPER INSTALLATION AND CARE MAY VOID WARRANTY. THESE INSTRUCTIONS ARE A BASIC GENERAL RECOMMENDATION FOR INSTALLATION, AND MAY NOT BE UTILIZED IN EVERY APPLICATION METHOD. THE MANUFACTURER ASSUMES NO RESPONSIBILITY FOR FAILURE, PERFORMANCE OR INJURY FROM IMPROPER INSTALLATION METHODS, CARE AND OR USE.

Materials Needed:

- Screws...
 - 1 1/2" for fastening nail fin or brickmold
 - 2 1/4" for fastening thru interior of frame w/ cap plug (Option #2)
 - 4"x #5 pan head screw for fastening thru lock keepers (Option #1)
- High quality sealant w/ backer gun
- Straight Flashing or building wrap tape
- Shims
- Level
- Square
- Utility knife
- 1/8" metal drill bit
- 3/8" drill bit
- Beit Insulation or non-expanding window/door foam

Installing the Door:

OPTION #2

(fastening using 3/8" Cap plugs method)

1. **Prep opening and verify measurements. Flash, shim, seal the door accordingly and per industry standards and codes.**
2. Set the bottom of the door sill onto the sill plate and carefully tilt push the door frame into the opening until the nail flange or brickmold is secured against the sheathing. Center the door and tack it into place before setting the shims and squaring up the door.
3. Make sure the door sill is level/straight and the side jambs are plumb and square (shim accordingly)!
**If the frame of the PD sill is sagging or bowing in any fashion, it will cause the door panels to operate, lock and seal improperly and may cause future damage to the door and it may not perform to its designed specifications!
4. Put 3-4 sets of shims along side jambs and header (if of shim locations varies depending on the size of the door) and align the shims with the lock keepers or where you will be pre-drilling a 1/8" hole for your fastening screws or using the 3/8" cap plugs.
5. ** Minnkota Windows recommends to use Option #1 to secure and fasten the mainframe to the sill/floor thru the sill keepers.
6. With operating sash panels open, pre-drill a 1/8" hole thru vinyl and steel reinforcement.
7. Next drill a 3/8" hole through the 1st layer of vinyl for fastening the screw to the king stud and header, keeping the frame straight and level for optimal performance (DO NOT over tighten or distort jamb/mainframe).
8. Close the door panels and adjust shims accordingly so that the gap between the sash panels and side jambs, header and sill of the frame are uniform or that the reveals are consistent. Check the door for proper operation and function and re-adjust if necessary!
9. Finish fastening screws thru nail flange or Retro BM. Apply industry standard flashing over nail flange and screws/nails to insure air and water tightness.
10. Insulate between frame and rough opening and finish trimming the interior and exterior as needed.
11. Apply the supplied 3/8" cap plugs and clean the sill after installation to clear debris from sill that may inhibit the locking points and/or drainage system of the door.

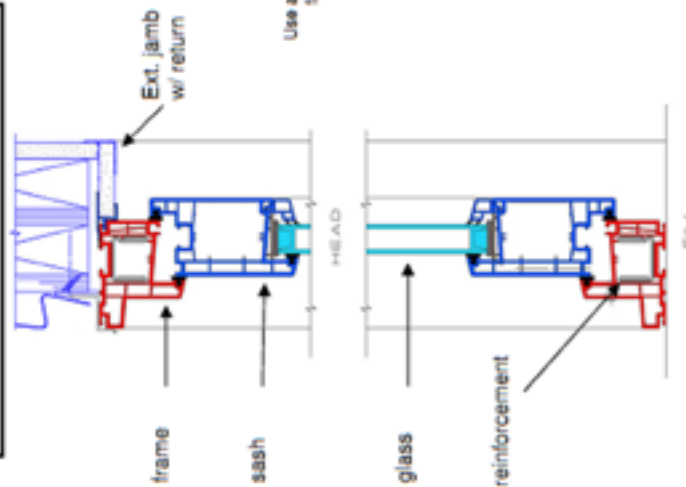

VERTICAL SECTION



HORIZONTAL SECTION

